

Doris (Cochrane Atrium)

5:40–5:55 pm S. Ross Browne
6:00–6:15 pm Dr. Faith Wilkerson
6:20–6:35 pm S. Ross Browne
6:40–6:55 pm Dr. Faith Wilkerson

Untitled (Cylindrical Lens) (21st Century Gallery)

5:40–5:55 pm Dr. Maurice Brown
6:00–6:15 pm Ashley Williams
6:20–6:35 pm Dr. Maurice Brown
6:40–6:55 pm Ashley Williams

Blues Singer #1 (American Gallery)

5:40–5:55 pm Kerri Grinnage
6:00–6:15 pm Michael Paul Williams
6:20–6:35 pm Kerri Grinnage
6:40–6:55 pm Michael Paul Williams

Untitled (East End Cemetery) (Photography Gallery)

5:40–5:55 pm Brian Palmer
6:00–6:15 pm Shakia Gullette Warren
6:20–6:35 pm Brian Palmer
6:40–6:55 pm Shakia Gullette Warren

No Way But This (Marble Hall)

7 pm Joshua Carter, Richmond Shakespeare

Richmond Shakespeare produces vital works of classical and contemporary theatre, with Shakespeare as their foundation.

The Virginia Museum of Fine Arts thanks all the African American Read-In participants for giving their time and talents to celebrate literature and art.



Virginia Museum of Fine Arts | 200 N. Arthur Ashe Blvd. | www.VMFA.museum

FRONT: *No Way But This*, 2013, Fred Wilson (American, born 1954), Murano glass. Virginia Museum of Fine Arts, Arthur and Margaret Glasgow Endowment, 2024.20

African American Read-In



Thu, Feb 20, 2025 | 5:30–7:30 pm | Free



VIRGINIA MUSEUM OF FINE ARTS

National African American Read-In

Literature and fine art come together at VMFA's African American Read-In (AARI). See and hear notable figures from the greater Richmond community as they lend their voices in prose and poetry readings throughout the galleries. Experience evocative and poignant pairings of the literary and visual arts, highlighting works by African American artists in a powerful display of storytelling.

The National African American Read-In is sponsored by the Black Caucus of the National Council of Teachers of English and endorsed by the International Literacy Association.

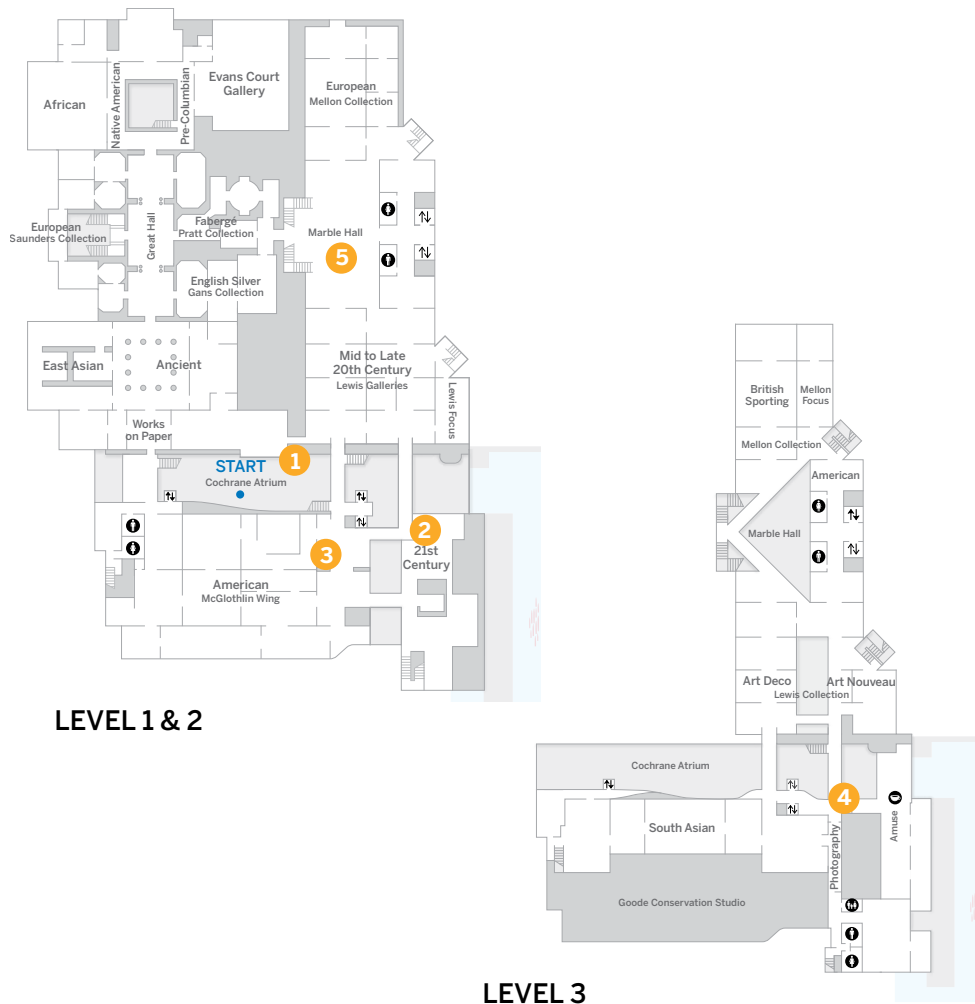

Artworks, Readers, and Readings

Gather in the Cochrane Atrium at 5:30 pm for a brief introduction to the program. From there, choose which reading to visit first. Readings have been paired with artworks in the museum and will last 15 minutes each, with five-minute intervals in between, allowing time to move to the next space.

You may visit the artworks in any order, but the readings will start promptly at the listed times:

5:40–5:55 pm
6:00–6:15 pm
6:20–6:35 pm
6:40–6:55 pm



- 1 Doris, Charles Searles, 1969**
Reading “Vote or Die” by Margaret Block
Location Cochrane Atrium, Smith Gallery
Readers S. Ross Browne and Dr. Faith Wilkerson



- 2 Untitled (Cylindrical Lens), Fred Eversley, 2023**
Reading “X Ray” by Danielle Legros Georges
Location 21st Century Gallery
Readers Dr. Maurice Brown and Ashley Williams



- 3 Blues Singer #1, Charles Henry Alston, ca. 1952**
Reading “The Weary Blues” by Langston Hughes
Location American Gallery
Readers Kerri Grinnage and Michael Paul Williams



- 4 Untitled (East End Cemetery), Brian Palmer, 2015**
Reading “The Bones of My Father” by Etheridge Knight
Location Photography Gallery
Reader Brian Palmer and Shakia Gullette Warren

At 7 pm, please join us in the Marble Hall for the reading of an excerpt from Shakespeare’s *Othello*, Act 5, Scene 2, by Joshua Carter, an actor from Richmond Shakespeare. *Othello* inspired Fred Wilson’s *No Way But This*.



- 5 No Way But This, Fred Wilson, 2013**
Reading Excerpt from *Othello*, Act 5, Scene 2
Location Marble Hall
Reader Joshua Carter, Richmond Shakespeare
Please note, *No Way But This* is located in the 1936 Entrance, but the reading will take place in the Marble Hall.